

Client:

Job Title:

Installation Instructions

1. Before installing Protecta® FR ASF ensure that the surface of all service penetrations and surrounding construction is free from all loose contaminants, dust and grease.
2. Where Protecta® FR ASF is to be installed against surfaces that cannot tolerate direct contact; appropriate surface preparation should be made (contact Polyseam for guidance in these cases). For paints sensitive to sealing compounds, priming with a PVA primer is recommended.
3. When installing the sealant in plasterboard, the exposed edges of the board can be wetted with water to prime the surfaces helping adhesion and preventing excessive joint shrinkage.
4. When installing any backing material, cut this slightly oversize and insert into the gap ensuring a tight friction fit. Ensure correct depth is achieved.
5. Fill the gap or joint with Protecta® FR ASF to the required depth.
6. Apply the sealant generously to prevent air bubbles. Finish the bead with a moist spatula, pallet knife or brush.
7. Protecta® FR ASF can be over-painted with most emulsion or alkyd (gloss) paints.

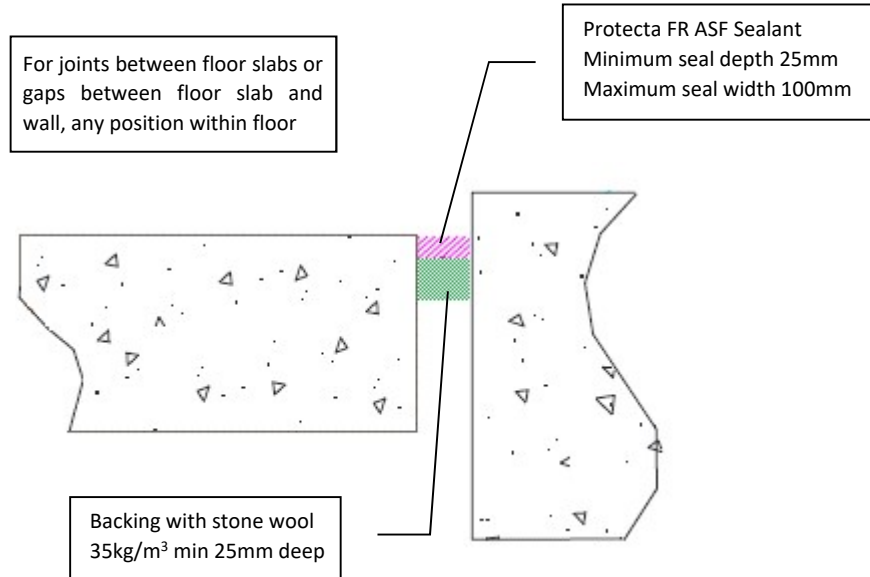

Products	Protecta FR ASF Sealant Stone wool
Application	Fire rated linear seals in rigid floors or between floors and walls
Construction	Minimum floor thickness of 64mm and comprise aerated concrete or concrete with a minimum density of 650kg/m ³ .

Fire Classification	
Floor thickness min 64mm	FRR -/90/90
Floor thickness min 150mm	FRR -/120/120



UL (UK) Ltd
4787654631
AS1530.4-2014

ETA 13/0879 & 13/0880



Protecta®

Polyseam Ltd, 15 St Andrews Road,
 Huddersfield, West Yorkshire, HD1 6SB
 Tel: +44 (0) 148 4421036
 Email: post.uk@polyseam.com

As a part of our policy of on-going product development and testing, we reserve the right to modify, alter or change product specifications without giving notice. All information contained in this document is given in good faith and is provided for guidance only. Any drawings provided are for illustrative purposes only. As Polyseam has no control over the methods or competence of installation and of prevailing site conditions, no warranties, expressed or implied, is intended to be given as to the actual performance of the product mentioned or referred to herein and no liability whatsoever will be accepted for any loss, damage or injury arising from the use of the information given.

For all technical details on the products specified please refer to the technical data sheets that can be found on www.firestopcentre.co.nz

Signed and approved:

Sheet size: A4	Drawn date & no: 24/5/18
Scale: NTS	Drawn by: K.B